

# USD 320 Wamego-Phase 2-Bid Package 3- Wamego Middle School Science Addition

## Addendum 1

Issue Date: 12-5-17

Architect: BBN Architects Inc.

MEP: Orazem & Scalora Engineering, P.A.

Civil Engineer: SMH Consultants

Construction Manager: Coonrod & Associates Construction Co., Inc.

Owner: USD 320 Wamego

The attached documents and / or items below shall hereby become part of the Construction Documents for the referenced project above.

**1-1:** There will be a non-mandatory, pre-bid meeting on Monday, December 11<sup>th</sup>, 2017 at 3:00 PM in the PLC (Professional Learning Center) Room located on the USD 320 District Office campus, 1008 8<sup>th</sup> St., Wamego, KS. Bidders are encouraged, but not required, to attend. A walk through of the site will be conducted after the meeting for anyone interested.

**1-2:** The attached bid scopes shall become part of the bid / construction documents.

**1-3:** The attached specification sections shall become part of the bid documents.

- ***115213- Projection Screens***
- ***123623- Plastic Laminate Clad Countertops***
- ***Geo-Rpt Science Wing Addition***

**END OF ADDENDUM**

**USD 320 Wamego- PH2 BP3- WMS Science Addition**

*These are the preferred bid scopes. It is the intent to select the lowest, responsible bidder or combination of bidders to provide the most benefit economically to the owner. The owner, architect, engineer and / or construction manager reserve the right to reject any and all bids.*

**BID SCOPES**

<b>BID SCOPES</b>	<b>Specification Section Name</b>	<b>Description</b>
<b>02A-Demolition</b>		
02.41.19	Selective Demolition	Complete- Labor and equipment to demo items per plans.
<b>03A- Concrete</b>		
03.30.00	Cast-In-Place Concrete	Complete- Labor, material and equipment
03.33.00	Architectural Concrete	Complete- Labor and equipment to demo items per plans.
<b>04A- Masonry</b>		
04.20.00	Unit Masonry	Complete- Labor and equipment to demo items per plans.
<b>05A- Steel</b>		
05.12.00	Structural Steel Framing	Furnish material only to jobsite
05.21.00	Steel Joist Framing	Furnish material only to jobsite
05.31.00	Steel Decking	Furnish material only to jobsite
05.50.00	Metal Fabrications	Furnish material only to jobsite
<b>05B- Steel Erection</b>		
05.12.00	Structural Steel Framing	Labor and equipment to install
05.21.00	Steel Joist Framing	Labor and equipment to install
05.31.00	Steel Decking	Labor and equipment to install
05.50.00	Metal Fabrications	Labor and equipment to install
<b>06A- Rough Carpentry</b>		
06.10.00	Rough Carpentry	Complete- Labor, material and equipment
<b>07A- Sealants</b>		
07.92.00	Joint Sealants	Complete- Labor, material and equipment
<b>07B- Roofing</b>		
07.41.16	Standing Seam Metal Roof Panels	Complete- Labor, material and equipment
07.42.93	Soffit Panels	Complete- Labor, material and equipment
07.71.00	Roof Specialties	Complete- Labor, material and equipment
07.72.53	Snow Guards	Complete- Labor, material and equipment
<b>07C- Expansion Joint Assemblies</b>		
07.95.00	Expansion Joint Cover Assemblies	Furnish material only to jobsite
<b>08A- Doors, Hardware, Frames</b>		
08.11.13	Hollow Metal Doors & Frames	Furnish material only to jobsite
08.14.16	Flush Wood Doors	Furnish material only to jobsite
08.31.13	Access Doors & Frames	Furnish material only to jobsite
08.71.30	Door Hardware - Science Wing-EXCLUDING ALUMINUM HARDWARE	Furnish material only to jobsite
<b>08B- Glass, Glazing</b>		
08.80.00	Glazing	Complete- Labor, material and equipment
08.41.13	Aluminum-Framed Entrances & Storefronts	Complete- Labor, material and equipment
08.71.30	Door Hardware - Science Wing-EXCLUDING ALUMINUM HARDWARE	Complete- Labor, material and equipment
08.51.13	Aluminum Windows	Complete- Labor, material and equipment
<b>09A- Drywall &amp; Acoustics</b>		

**USD 320 Wamego- PH2 BP3- WMS Science Addition**

*These are the preferred bid scopes. It is the intent to select the lowest, responsible bidder or combination of bidders to provide the most benefit economically to the owner. The owner, architect, engineer and / or construction manager reserve the right to reject any and all bids.*

**BID SCOPES**

<b>BID SCOPES</b>	<b>Specification Section Name</b>	<b>Description</b>
05.40.00	Cold-Formed Metal Framing	Complete- Labor, material and equipment
07.21.00	Thermal Insulation	For this bid package ONLY- Labor, material and equipment
09.21.16	Gypsum Board Assemblies	Complete- Labor, material and equipment
09.51.13	Acoustical Panel Ceilings	Complete- Labor, material and equipment
09.84.23	Fabric Wrapped Sound-Absorbing Panels	Complete- Labor, material and equipment
<b>09B- Flooring</b>		
09.65.13	Resilient Base & Accessories	Complete- Labor, material and equipment
09.65.16	Resilient Sheet Flooring	Complete- Labor, material and equipment
09.65.19	Resilient Tile Flooring	Complete- Labor, material and equipment
09.68.13	Tile Carpeting	Complete- Labor, material and equipment
<b>09C- Painting</b>		
09.61.13	Floor Sealers	Complete- Labor, material and equipment
09.91.13	Exterior Painting	Complete- Labor, material and equipment
09.91.23	Interior Painting	Complete- Labor, material and equipment
<b>10A- Glass Markerboards</b>		
10.11.16	Glass Markerboards	Furnish material only to jobsite
<b>10B- Toilet &amp; Bath Accessories</b>		
10.28.00	Toilet & Bath Accessories	Furnish material only to jobsite
<b>10C- Fire Protection Specialties</b>		
10.44.00	Fire Protection Specialties	Furnish material only to jobsite
<b>10D- Fire Extinguishers</b>		
10.44.16	Fire Extinguishers	Furnish material only to jobsite
<b>11A- Projection Screens</b>		
11.52.13	Projection Screens	Furnish material only to jobsite
<b>12A- Roller Window Shades</b>		
12.24.13	Roller Window Shades	Complete- Labor, material and equipment
<b>12B- Plastic Clad Tops</b>		
12.36.23	Plastic Laminate Clad Countertops	Furnish material only to jobsite
<b>12C- Wood Laboratory Casework</b>		
12.35.59	Wood Laboratory Casework	Complete- Labor, material and equipment
<b>12D- Solid Surfacing Countertops</b>		
12.24.13	Solid Surfacing Countertops	Furnish material only to jobsite
<b>22A- Plumbing</b>		
22.00.00	Plumbing	Complete- Labor, material and equipment
<b>23A- HVAC</b>		
23.01.00	Basic Mechanical Requirements	Complete-Labor, material and equipment
23.25.00	Insulation (Mechanical)	Complete-Labor, material and equipment
23.60.00	Heating Equipment	Complete-Labor, material and equipment
23.65.10	Rooftop Heating/Cooling Units	Complete-Labor, material and equipment

**USD 320 Wamego- PH2 BP3- WMS Science Addition**

*These are the preferred bid scopes. It is the intent to select the lowest, responsible bidder or combination of bidders to provide the most benefit economically to the owner. The owner, architect, engineer and / or construction manager reserve the right to reject any and all bids.*

**BID SCOPES**

<b>BID SCOPES</b>	<b>Specification Section Name</b>	<b>Description</b>
23.65.75	Rooftop Heating Only Outside Air Supply Units	Complete-Labor, material and equipment
23.80.00	HVAC Equipment - Air Side	Complete-Labor, material and equipment
23.85.00	Ductwork & Accessories	Complete-Labor, material and equipment
23.99.00	Testing, Adjusting, and Balancing (HVAC)	Complete-Labor, material and equipment
25.90.00	Temperature Controls	Complete- Labor, material and equipment
<b>26A- Electrical</b>		
26.01.00	Basic Electrical Requirements	Complete- Labor, material and equipment
26.01.50	Ice & Snow Melting for Pavement	Complete- Labor, material and equipment
26.16.00	Power Distribution Equipment	Complete- Labor, material and equipment
26.17.00	Motor & Circuit Disconnects	Complete- Labor, material and equipment
26.41.30	Standby Generator Systems - Natural Gas Engine	Complete- Labor, material and equipment
26.41.60	Automatic Transfer Switches	Complete- Labor, material and equipment
26.50.00	Lighting	Complete- Labor, material and equipment
26.51.00	Site Lighting	Complete- Labor, material and equipment
27.88.00	Intercom Systems	
28.72.10	Fire-Alarm Systems	Complete- Labor, material and equipment
<b>31A- Sitework / Site Demo</b>		
31.20.00	Earth Moving	Complete- Labor, material and equipment
<b>31B- Termite Control</b>		
31.31.16	Termite Control	Complete- Labor, material and equipment
<b>32A- Paving</b>		
	Concrete Paving	Complete- Labor, material and equipment
<b>33A- Site Utilities</b>		
Div. 33	Site Utilities	Complete- Labor, material and equipment- within 5 ft. of building, furnish and install rain leaders and adapters
<b>50A- Carpentry</b>		
07.95.00	Expansion Joint Cover Assemblies	Labor and equipment to install
08.11.13	Hollow Metal Doors & Frames	Labor and equipment to install
08.14.16	Flush Wood Doors	Labor and equipment to install
08.31.13	Access Doors & Frames	Labor and equipment to install
08.71.30	Door Hardware - Science Wing-EXCLUDING ALUMINUM HARDWARE	Labor and equipment to install
10.11.16	Glass Markerboards	Labor and equipment to install
10.28.00	Toilet & Bath Accessories	Labor and equipment to install
10.44.00	Fire Protection Specialties	Labor and equipment to install
10.44.16	Fire Extinguishers	Labor and equipment to install
11.52.13	Projection Screens	Labor and equipment to install
12.36.23	Plastic Laminate Clad Countertops	Labor and equipment to install
12.24.13	Solid Surfacing Countertops	Labor and equipment to install

Bidders can bid on any of these items.

**SECTION 11 52 13 - PROJECTION SCREENS****PART 1 - GENERAL****1.1 RELATED DOCUMENTS**

- A. Drawings and general provisions of the Contract, including General and Supplementary Conditions and Division 01 Specification Sections, apply to this Section.

**1.2 SUMMARY**

- A. Section Includes:
  - 1. Manually operated, front-projection screens.
- B. Related Requirements:
  - 1. Section 05 50 00 "Metal Fabrications" for metal support framing for front-projection screens.
  - 2. Section 06 10 00 "Rough Carpentry" for wood backing for screen installation.

**1.3 DEFINITIONS**

- A. Gain: Ratio of light reflected from screen material to that reflected perpendicularly from a magnesium carbonate surface as determined per SMPTE RP 94.
- B. Half-Gain Angle: The angle, measured from the axis of the screen surface to the most central position on a perpendicular plane through the horizontal centerline of the screen where the gain is half of the peak gain.

**1.4 ACTION SUBMITTALS**

- A. Product Data: For each type of product.
- B. Shop Drawings: Show layouts and types of front-projection screens. Include the following:
  - 1. Drop lengths.
  - 2. Location of seams in viewing surfaces.
  - 3. Location of screen centerline relative to ends of screen case.
  - 4. Details of juncture of exposed surfaces with adjacent finishes.
  - 5. Accessories.
- C. Samples for Initial Selection: For finishes of surface-mounted screen cases.

**1.5 CLOSEOUT SUBMITTALS**

- A. Maintenance Data: For front-projection screens to include in maintenance manuals.

**1.6 DELIVERY, STORAGE, AND HANDLING**

- A. Environmental Limitations: Do not deliver or install front-projection screens until spaces are enclosed and weathertight, wet work in spaces is complete and dry, and temporary HVAC system is operating and maintaining ambient temperature and humidity conditions at occupancy levels during the remainder of the construction period.

**PART 2 - PRODUCTS****2.1 MANUFACTURERS**

- A. Source Limitations for Projection Screens: Obtain front-projection screens from single manufacturer. Obtain accessories, including necessary mounting hardware, from screen manufacturer.

**2.2 MANUALLY OPERATED, FRONT-PROJECTION SCREENS**

- A. General: Manufacturer's standard spring-roller-operated units, consisting of case, screen, mounting accessories, and other components necessary for a complete installation.
1. Screen Mounting: Top edge securely anchored to a 3-inch- (75-mm-) diameter, rigid steel roller; bottom edge formed into a pocket holding a tubular metal slat, with ends of slat protected by plastic caps, and with a saddle and pull attached to slat by screws.
- B. Bracket-Mounted, Metal-Encased, Manually Operated Screens without Tab Tensioning: Units designed and fabricated for suspending from wall brackets, fabricated from formed-steel sheet not less than 0.027 inch (0.7 mm) thick or from aluminum extrusions; with baked-enamel finish and matching end caps. Provide mounting brackets to allow for 6 inch (150 mm) extension from wall.
1. Basis-of-Design Product: Subject to compliance with requirements, provide Da-Lite Screen Company; Model B or comparable product by one of the following:
    - a. Bretford, Inc.
    - b. Draper Inc.
- C. Case and Bracket Finish Color: Black

**2.3 FRONT-PROJECTION SCREEN MATERIAL**

- A. Matte-White Viewing Surface: Peak gain of not less than 1.0 and gain of not less than 0.8 at a half-angle of 60 degrees from the axis of the screen surface.

1. Basis-of-Design Product: Subject to compliance with requirements, provide Da-Lite Screen Company; Matte White or comparable product by one of the following:
  - a. Bretford, Inc.
  - b. Draper Inc.
- B. Material: Vinyl-coated, glass-fiber fabric.
- C. Mildew-Resistance Rating: Zero or 1 when tested according to ASTM G 21.
- D. Flame Resistance: Passes NFPA 701.
- E. Flame-Spread Index: Not greater than 75 when tested according to ASTM E 84.
- F. Seamless Construction: Provide screens, in sizes indicated, without seams.
- G. Edge Treatment: Black masking borders.
- H. Size of Viewing Surface: 52 by 92 inches (1321 by 2337 mm).

### **PART 3 - EXECUTION**

#### **3.1 INSTALLATION**

- A. Install front-projection screens at locations indicated to comply with screen manufacturer's written instructions.
- B. Install front-projection screens with screen cases in position and in relation to adjoining construction indicated. Securely anchor to supporting substrate in a manner that produces a smoothly operating screen with vertical edges plumb and viewing surface flat when screen is lowered.
  1. Test manually operated units to verify that screen-operating components are in optimum functioning condition.

END OF SECTION 11 52 13

This page is intentionally left blank.



---

**SECTION 12 36 23 - PLASTIC-LAMINATE-CLAD COUNTERTOPS**

**PART 1 - GENERAL**

**1.1 RELATED DOCUMENTS**

- A. Drawings and general provisions of the Contract, including General and Supplementary Conditions and Division 01 Specification Sections, apply to this Section.

**1.2 SUMMARY**

- A. Section includes plastic-laminate countertops.

**1.3 ACTION SUBMITTALS**

- A. Product Data: For each type of product, including panel products, high-pressure decorative laminate, and adhesive for bonding plastic laminate.
  - 1. Include data for fire-retardant treatment from chemical-treatment manufacturer and certification by treating plant that treated materials comply with requirements.
- B. Shop Drawings: Show location of each item, dimensioned plans and elevations, large-scale details, attachment devices, and other components.
  - 1. Show locations and sizes of cutouts and holes for plumbing fixtures, faucets, and other items installed in plastic-laminate countertops.
- C. Samples for Verification:
  - 1. Plastic laminates, 8 by 10 inches (200 by 250 mm), for each type, color, pattern, and surface finish, with one sample applied to core material and specified edge material applied to one edge.

**1.4 INFORMATIONAL SUBMITTALS**

- A. Qualification Data: For fabricator.
- B. Product Certificates: For each type of product.
  - 1. Composite wood products.
  - 2. High-pressure decorative laminate.
  - 3. Adhesives.
- C. Woodwork Quality Standard Compliance Certificates: AWI Quality Certification Program certificates.
- D. Evaluation Reports: For fire-retardant-treated materials, from ICC-ES.

**1.5 QUALITY ASSURANCE**

- A. Fabricator Qualifications: Shop that employs skilled workers who custom fabricate products similar to those required for this Project and whose products have a record of successful in-service performance. Shop is a certified participant in AWI's Quality Certification Program.
- B. Installer Qualifications: Fabricator of products.
- C. Testing Agency Qualifications: For testing agency providing classification marking for fire-retardant-treated material, an inspection agency acceptable to authorities having jurisdiction that periodically performs inspections to verify that the material bearing the classification marking is representative of the material tested.

**1.6 DELIVERY, STORAGE, AND HANDLING**

- A. Do not deliver countertops until painting and similar operations that could damage countertops have been completed in installation areas. If countertops must be stored in other than installation areas, store only in areas where environmental conditions comply with requirements specified in "Field Conditions" Article.

**1.7 FIELD CONDITIONS**

- A. Environmental Limitations: Do not deliver or install countertops until building is enclosed, wet work is complete, and HVAC system is operating and maintaining temperature between 60 and 90 deg F (16 and 32 deg C) and relative humidity between 43 and 70 percent during the remainder of the construction period.
- B. Field Measurements: Verify dimensions of countertops by field measurements after base cabinets are installed but before countertop fabrication is complete.

**PART 2 - PRODUCTS****2.1 PLASTIC-LAMINATE COUNTERTOPS**

- A. Quality Standard: Unless otherwise indicated, comply with the "Architectural Woodwork Standards" for grades indicated for construction, installation, and other requirements.
  - 1. Provide labels from AWI certification program indicating that countertops, including installation, comply with requirements of grades specified.
  - 2. The Contract Documents contain selections chosen from options in the quality standard and additional requirements beyond those of the quality standard. Comply with those selections and requirements in addition to the quality standard.
- B. Grade: Custom.
- C. High-Pressure Decorative Laminate: NEMA LD 3, Grade HGP.

1. Basis-of-Design Product: The design is based on the products named in the Material Finish Legend. Subject to compliance with requirements, provide either the named products or comparable products by one of the following:
    - a. Abet Laminati Inc.
    - b. Formica Corporation.
    - c. Lamin-Art, Inc.
    - d. Nevamar; a Panolam Industries International, Inc. brand.
    - e. Pionite; a Panolam Industries International, Inc. brand.
    - f. Wilsonart LLC.
  2. Colors, Patterns, and Finishes: As selected by the Architect from the manufacturer's full range of colors.
- D. Edge Treatment: Same as laminate cladding on horizontal surfaces with 1/2-inch (12.7 mm) radius waterfall edge.
- E. Core Material: Medium-Density Fiberboard: ANSI A208.2, Grade MD-Exterior Glue.
- F. Core Thickness: 3/4 inch (19 mm). Build up countertop thickness to 1-1/2 inches (38 mm) at front, back, and ends with additional layers of core material laminated to top.

## 2.2 WOOD MATERIALS

- A. Composite Wood Products: Provide materials that comply with requirements of referenced quality standard for each type of woodwork and quality grade specified unless otherwise indicated. Urea formaldehyde free.
1. Medium-Density Fiberboard: ANSI A208.2, Grade 130.
  2. Particleboard: ANSI A208.1, Grade M-2-Exterior Glue.
    - a. Manufacturers: Subject to compliance with requirements, provide products by one of the following:
      - 1) Environ Biocomposites Manufacturing LLC.
      - 2) Sierra Pine Composite Solutions.
      - 3) Sorm Incorporated.
- B. Fire-retardant-treated materials.

## 2.3 MISCELLANEOUS MATERIALS

- A. Adhesive for Bonding Plastic Laminate: Unpigmented contact cement.
1. Adhesive for Bonding Edges: Hot-melt adhesive or adhesive specified above for faces.
- B. Adhesives: Urea formaldehyde free.

**2.4 FABRICATION**

- A. Sand fire-retardant-treated wood lightly to remove raised grain on exposed surfaces before fabrication.
- B. Fabricate countertops to dimensions, profiles, and details indicated. Provide front and end overhang of 1 inch (25 mm) over base cabinets. Ease edges to radius indicated for the following:
- C. Complete fabrication, including assembly, to maximum extent possible before shipment to Project site. Disassemble components only as necessary for shipment and installation. Where necessary for fitting at site, provide ample allowance for scribing, trimming, and fitting.
  - 1. Notify Architect seven days in advance of the dates and times woodwork fabrication will be complete.
  - 2. Trial fit assemblies at fabrication shop that cannot be shipped completely assembled. Install dowels, screws, bolted connectors, and other fastening devices that can be removed after trial fitting. Verify that various parts fit as intended and check measurements of assemblies against field measurements before disassembling for shipment.

**PART 3 - EXECUTION****3.1 PREPARATION**

- A. Before installation, condition countertops to average prevailing humidity conditions in installation areas.
- B. Before installing countertops, examine shop-fabricated work for completion and complete work as required, including removal of packing and backpriming.

**3.2 INSTALLATION**

- A. Grade: Install countertops to comply with same grade as item to be installed.
- B. Assemble countertops and complete fabrication at Project site to the extent that it was not completed in the shop.
  - 1. Provide cutouts for appliances, plumbing fixtures, electrical work, and similar items.
  - 2. Seal edges of cutouts by saturating with varnish.
- C. Field Jointing: Where possible, make in the same manner as shop jointing, using dowels, splines, adhesives, and fasteners recommended by manufacturer. Prepare edges to be joined in shop so Project-site processing of top and edge surfaces is not required. Locate field joints where shown on Shop Drawings.
  - 1. Secure field joints in plastic-laminate countertops with concealed clamping devices located within 6 inches (150 mm) of front and back edges and at intervals not exceeding

24 inches (600 mm). Tighten according to manufacturer's written instructions to exert a constant, heavy-clamping pressure at joints.

- D. Install countertops level, plumb, true, and straight. Shim as required with concealed shims. Install level and plumb to a tolerance of 1/8 inch in 96 inches (3 mm in 2400 mm).
- E. Scribe and cut countertops to fit adjoining work, refinish cut surfaces, and repair damaged finish at cuts.
- F. Fire-Retardant-Treated Wood: Handle, store, and install fire-retardant-treated wood to comply with chemical treatment manufacturer's written instructions, including those for adhesives used to install woodwork.
- G. Countertops: Anchor securely by screwing through corner blocks of base cabinets or other supports into underside of countertop.
  - 1. Install countertops with no more than 1/8 inch in 96-inch (3 mm in 2400-mm) sag, bow, or other variation from a straight line.
  - 2. Seal junctures of tops and walls with mildew-resistant silicone sealant or another permanently elastic sealing compound recommended by countertop material manufacturer.

### 3.3 ADJUSTING AND CLEANING

- A. Repair damaged and defective countertops, where possible, to eliminate functional and visual defects; where not possible to repair, replace woodwork. Adjust joinery for uniform appearance.
- B. Clean countertops on exposed and semiexposed surfaces. Touch up shop-applied finishes to restore damaged or soiled areas.

END OF SECTION 12 36 23

This page is intentionally left blank.

**GEOTECHNICAL EXPLORATION REPORT**  
**Proposed Science Wing Addition**  
**Wamego Middle School**  
**Wamego, Kansas**

GSI Project No. 1773023C  
March 8, 2017

---

**Prepared by:**

GSI Engineering, LLC  
4503 East 47<sup>th</sup> Street South  
Wichita, Kansas 67210  
(316) 554-0725

---

**Prepared for:**

USD 320  
Wamego School District  
1008 8<sup>th</sup> Street  
Wamego, Kansas 66547

# Important Information about This

# Geotechnical-Engineering Report

Subsurface problems are a principal cause of construction delays, cost overruns, claims, and disputes.

While you cannot eliminate all such risks, you can manage them. The following information is provided to help.

## Geotechnical Services Are Performed for Specific Purposes, Persons, and Projects

Geotechnical engineers structure their services to meet the specific needs of their clients. A geotechnical-engineering study conducted for a civil engineer may not fulfill the needs of a constructor — a construction contractor — or even another civil engineer. Because each geotechnical-engineering study is unique, each geotechnical-engineering report is unique, prepared *solely* for the client. No one except you should rely on this geotechnical-engineering report without first conferring with the geotechnical engineer who prepared it. *And no one — not even you — should apply this report for any purpose or project except the one originally contemplated.*

## Read the Full Report

Serious problems have occurred because those relying on a geotechnical-engineering report did not read it all. Do not rely on an executive summary. Do not read selected elements only.

## Geotechnical Engineers Base Each Report on a Unique Set of Project-Specific Factors

Geotechnical engineers consider many unique, project-specific factors when establishing the scope of a study. Typical factors include: the client's goals, objectives, and risk-management preferences; the general nature of the structure involved, its size, and configuration; the location of the structure on the site; and other planned or existing site improvements, such as access roads, parking lots, and underground utilities. Unless the geotechnical engineer who conducted the study specifically indicates otherwise, do not rely on a geotechnical-engineering report that was:

- not prepared for you;
- not prepared for your project;
- not prepared for the specific site explored; or
- completed before important project changes were made.

Typical changes that can erode the reliability of an existing geotechnical-engineering report include those that affect:

- the function of the proposed structure, as when it's changed from a parking garage to an office building, or from a light-industrial plant to a refrigerated warehouse;
- the elevation, configuration, location, orientation, or weight of the proposed structure;
- the composition of the design team; or
- project ownership.

As a general rule, *always* inform your geotechnical engineer of project changes—even minor ones—and request an

assessment of their impact. *Geotechnical engineers cannot accept responsibility or liability for problems that occur because their reports do not consider developments of which they were not informed.*

## Subsurface Conditions Can Change

A geotechnical-engineering report is based on conditions that existed at the time the geotechnical engineer performed the study. *Do not rely on a geotechnical-engineering report whose adequacy may have been affected by:* the passage of time; man-made events, such as construction on or adjacent to the site; or natural events, such as floods, droughts, earthquakes, or groundwater fluctuations. *Contact the geotechnical engineer before applying this report to determine if it is still reliable.* A minor amount of additional testing or analysis could prevent major problems.

## Most Geotechnical Findings Are Professional Opinions

Site exploration identifies subsurface conditions only at those points where subsurface tests are conducted or samples are taken. Geotechnical engineers review field and laboratory data and then apply their professional judgment to render an opinion about subsurface conditions throughout the site. Actual subsurface conditions may differ — sometimes significantly — from those indicated in your report. Retaining the geotechnical engineer who developed your report to provide geotechnical-construction observation is the most effective method of managing the risks associated with unanticipated conditions.

## A Report's Recommendations Are Not Final

Do not overrely on the confirmation-dependent recommendations included in your report. *Confirmation-dependent recommendations are not final*, because geotechnical engineers develop them principally from judgment and opinion. Geotechnical engineers can finalize their recommendations *only* by observing actual subsurface conditions revealed during construction. *The geotechnical engineer who developed your report cannot assume responsibility or liability for the report's confirmation-dependent recommendations if that engineer does not perform the geotechnical-construction observation required to confirm the recommendations' applicability.*

## A Geotechnical-Engineering Report Is Subject to Misinterpretation

Other design-team members' misinterpretation of geotechnical-engineering reports has resulted in costly



problems. Confront that risk by having your geotechnical engineer confer with appropriate members of the design team after submitting the report. Also retain your geotechnical engineer to review pertinent elements of the design team's plans and specifications. Constructors can also misinterpret a geotechnical-engineering report. Confront that risk by having your geotechnical engineer participate in prebid and preconstruction conferences, and by providing geotechnical construction observation.

### **Do Not Redraw the Engineer's Logs**

Geotechnical engineers prepare final boring and testing logs based upon their interpretation of field logs and laboratory data. To prevent errors or omissions, the logs included in a geotechnical-engineering report should *never* be redrawn for inclusion in architectural or other design drawings. Only photographic or electronic reproduction is acceptable, *but recognize that separating logs from the report can elevate risk.*

### **Give Constructors a Complete Report and Guidance**

Some owners and design professionals mistakenly believe they can make constructors liable for unanticipated subsurface conditions by limiting what they provide for bid preparation. To help prevent costly problems, give constructors the complete geotechnical-engineering report, *but* preface it with a clearly written letter of transmittal. In that letter, advise constructors that the report was not prepared for purposes of bid development and that the report's accuracy is limited; encourage them to confer with the geotechnical engineer who prepared the report (a modest fee may be required) and/or to conduct additional study to obtain the specific types of information they need or prefer. A prebid conference can also be valuable. *Be sure constructors have sufficient time* to perform additional study. Only then might you be in a position to give constructors the best information available to you, while requiring them to at least share some of the financial responsibilities stemming from unanticipated conditions.

### **Read Responsibility Provisions Closely**

Some clients, design professionals, and constructors fail to recognize that geotechnical engineering is far less exact than other engineering disciplines. This lack of understanding has created unrealistic expectations that have led to disappointments, claims, and disputes. To help reduce the risk of such outcomes, geotechnical engineers commonly include a variety of explanatory provisions in their reports. Sometimes labeled "limitations," many of these provisions indicate where geotechnical engineers' responsibilities begin and end, to help

others recognize their own responsibilities and risks. *Read these provisions closely.* Ask questions. Your geotechnical engineer should respond fully and frankly.

### **Environmental Concerns Are Not Covered**

The equipment, techniques, and personnel used to perform an *environmental* study differ significantly from those used to perform a *geotechnical* study. For that reason, a geotechnical-engineering report does not usually relate any environmental findings, conclusions, or recommendations; e.g., about the likelihood of encountering underground storage tanks or regulated contaminants. *Unanticipated environmental problems have led to numerous project failures.* If you have not yet obtained your own environmental information, ask your geotechnical consultant for risk-management guidance. *Do not rely on an environmental report prepared for someone else.*

### **Obtain Professional Assistance To Deal with Mold**

Diverse strategies can be applied during building design, construction, operation, and maintenance to prevent significant amounts of mold from growing on indoor surfaces. To be effective, all such strategies should be devised for the *express purpose* of mold prevention, integrated into a comprehensive plan, and executed with diligent oversight by a professional mold-prevention consultant. Because just a small amount of water or moisture can lead to the development of severe mold infestations, many mold-prevention strategies focus on keeping building surfaces dry. While groundwater, water infiltration, and similar issues may have been addressed as part of the geotechnical-engineering study whose findings are conveyed in this report, the geotechnical engineer in charge of this project is not a mold prevention consultant; *none of the services performed in connection with the geotechnical engineer's study were designed or conducted for the purpose of mold prevention. Proper implementation of the recommendations conveyed in this report will not of itself be sufficient to prevent mold from growing in or on the structure involved.*

### **Rely, on Your GBC-Member Geotechnical Engineer for Additional Assistance**

Membership in the Geotechnical Business Council of the Geoprofessional Business Association exposes geotechnical engineers to a wide array of risk-confrontation techniques that can be of genuine benefit for everyone involved with a construction project. Confer with you GBC-Member geotechnical engineer for more information.



8811 Colesville Road/Suite G106, Silver Spring, MD 20910  
Telephone: 301/565-2733 Facsimile: 301/589-2017  
e-mail: [info@geoprofessional.org](mailto:info@geoprofessional.org) [www.geoprofessional.org](http://www.geoprofessional.org)

Copyright 2015 by Geoprofessional Business Association (GBA). Duplication, reproduction, or copying of this document, or its contents, in whole or in part, by any means whatsoever, is strictly prohibited, except with GBA's specific written permission. Excerpting, quoting, or otherwise extracting wording from this document is permitted only with the express written permission of GBA, and only for purposes of scholarly research or book review. Only members of GBA may use this document as a complement to or as an element of a geotechnical-engineering report. Any other firm, individual, or other entity that so uses this document without being a GBA member could be committing negligent or intentional (fraudulent) misrepresentation.



**TABLE OF CONTENTS**

	<u>Page No.</u>
<b>1. INTRODUCTION</b> .....	<b>1-1</b>
1.1 General.....	1-1
1.2 Project Description.....	1-1
<b>2. FIELD EXPLORATION</b> .....	<b>2-1</b>
<b>3. SITE CONDITIONS</b> .....	<b>3-1</b>
3.1 Regional Geology .....	3-1
3.2 Surface Conditions.....	3-1
3.3 Subsurface Conditions.....	3-1
3.4 Groundwater Conditions .....	3-2
<b>4. LABORATORY TESTING</b> .....	<b>4-1</b>
<b>5. CONCLUSIONS AND RECOMMENDATIONS</b> .....	<b>5-1</b>
5.1 General Geotechnical Considerations.....	5-1
5.2 Earthwork .....	5-1
5.2.1 Site Preparation.....	5-1
5.2.2 General Structural Fill.....	5-2
5.2.3 Low Volume Change Material (LVC) .....	5-2
5.2.4 Chemical Stabilization of Soil .....	5-3
5.2.5 Compaction of Engineered Structural Fills.....	5-4
5.2.6 Utility Trench Backfill .....	5-5
5.2.7 Foundation Backfill .....	5-6
5.2.8 Correction of Unsuitable Foundation Soils.....	5-6
5.2.9 Excavation Slopes.....	5-6
5.3 Foundations.....	5-7
5.4 Floor Slabs .....	5-9
5.5 Surface Drainage and Landscaping .....	5-10
5.6 Construction Considerations .....	5-11
5.7 Construction Observation and Quality Assurance .....	5-11
<b>6. CLOSING REMARKS AND LIMITATIONS</b> .....	<b>6-1</b>
 <b>APPENDICES</b>	
Appendix A - General Vicinity Map Boring Location Plan	
Appendix B - Boring Logs Key to Symbols Legend & Nomenclature Unified Soil Classification System (USCS)	
Appendix C - Field & Laboratory Test Results	



## 1. INTRODUCTION

### 1.1 General

This report summarizes the findings of our geotechnical exploration for the proposed Science Wing addition located at the Wamego Middle School in Wamego, Kansas. The scope of work was outlined in our proposal dated January 17, 2017. Mr. Patrick Schaub of Unified School District (USD) 320 authorized this exploration on February 1, 2017.

The purpose of this geotechnical study is to explore the subsurface conditions at the proposed site with exploratory borings, evaluate the engineering properties of the subsurface materials with appropriate field and laboratory tests, and perform engineering analyses for developing design and construction recommendations for the proposed project.

### 1.2 Project Description

We understand the proposed project involves the construction of a science wing addition at the existing Wamego Middle School. The proposed single-story structure has a plan area of 8,850 square feet. We understand the proposed structure will be of concrete masonry unit (CMU) or steel frame construction with a concrete slab-on-grade first floor. We estimate that the structure will have maximum column and continuous wall loads on the order of 40 kips and 3 kips per lineal foot, respectively.

We assume site grading required to bring the building pad to the desired elevation will be minimal, with cuts or fills of less than 2 feet.

A site plan is included in Appendix A for reference.

## 2. FIELD EXPLORATION

We drilled 4 borings for this geotechnical exploration on February 9, 2017 with a Mobile B-61 truck-mounted drilling rig using 3.25-inch inside diameter hollow stem augers. We drilled the borings within the building footprint to a depth of approximately 10 feet below the site grade at the time of our exploration.

Boring locations were indicated on a preliminary site sketch provided by Mr. Carl Riblett of BBN Architects. GSI personnel established field locations by measuring distances from reference points shown on this preliminary site plan. Locations of the borings in relation to existing and proposed features are indicated on the Boring Location Plan included in Appendix A. The locations of the borings should be considered accurate only to the degree implied by the methods used in their determination.

Our drill crew obtained soil samples at the intervals shown on the boring logs in Appendix B. Recovered samples were sealed in plastic containers, labeled, and protected for transportation to the laboratory for further examination, testing, and classification.

We obtained split-barrel samples (designated "Split Spoon" or "S" samples) while performing Standard Penetration Tests (SPT) with a 1-3/8 inch I.D. thick-walled sampler, driven using an automatic hammer in general accordance with ASTM D1586, "*Penetration Test and Split-Barrel Sampling of Soils.*" The "N" value, reported in blows per foot (bpf), equals the number of blows required to drive the sampler through the last 12 inches of the 18-inch sample interval using a 140-pound hammer falling 30 inches.

We obtained undisturbed samples (designated "Shelby Tube" or "U" samples) with 3-inch O.D. thin-walled tube samplers, hydraulically pushed in general accordance with ASTM D1587, "*Thin-Walled Tube Sampling of Soils for Geotechnical Purposes.*"

Our drilling personnel prepared field boring logs during drilling operations. These field logs report drilling and sampling methods, sampling intervals, groundwater measurements and the subsurface conditions we encountered. At the conclusion of drilling, our drill crew made groundwater measurements and backfilled the borings in accordance with Kansas state regulations.

### 3. SITE CONDITIONS

#### 3.1 Regional Geology

This project lies within the Glaciated geomorphic region of northeast Kansas. The topography of this region was created by the advance of Ice Age glaciers and is characterized by steeply rolling hills with areas of level upland divides and alluvial lowlands. Soil stratigraphy generally consists of Pre-Illinoian glacial till (drift) overlain in some areas by loess deposits of varying thickness. Pre-Illinoian glacial till consists of a well graded mixture of clay, silt, and sand having pebbles, cobbles, and occasional boulders. The loess is an eolian (wind-blown) deposit of clay and silt which tends to have a relatively uniform particle size and varies in thickness from a trace in the southwest portion of the region to over 100 feet along the Missouri River. In some areas, loess and glacial till have been eroded, creating residual soils weathered from the underlying bedrock. The surficial soils throughout the area are underlain by the Pennsylvanian bedrock system which consists of undifferentiated formations of shale and limestone.

#### 3.2 Surface Conditions

The proposed building site was located on the west end of the west wing of the existing middle school building. At the time of our exploration, the site was relatively flat and grass covered.

#### 3.3 Subsurface Conditions

Although we observed some variability, the subsurface materials we encountered within the depths of exploration generally comprised fat clay overlying lean clay. General descriptions of the strata we encountered are presented below, while more detailed subsurface information is presented on the boring logs located in Appendix B. Please note that the indicated depths are relative to the site grade at the time of our exploration.

##### Stratum 1

We encountered fat clay in borings MS-1, MS-2, and MS-4 underlying a 6-inch topsoil layer and extending to a depth of 2.5 feet. This material was generally described as dark gray, dark brown, or olive brown and moist. We measured Standard Penetration Test (SPT) N-values between 9 and 13 blows per foot (bpf), indicating the fat clay is in a stiff condition.



## **Stratum 2**

We encountered lean clay in all of our borings underlying a 6-inch topsoil layer or the fat clay at 2.5 feet and extending to the termination depth of the borings at 10 feet. This material was generally described as dark brown, olive brown, or dark yellowish brown and moist. We measured SPT N-values between 7 and 26 bpf and unconfined compressive strengths between 0.78 and 3.31 kips per square foot (ksf), indicating the lean clay is in a medium stiff to very stiff condition.

### **3.4 Groundwater Conditions**

Our drill crew made water level observations during drilling and after completion of the borings to evaluate groundwater conditions. We did not encounter groundwater in any of our soil borings.

The groundwater conditions we observed during our exploration program should not be construed to represent an absolute or permanent condition. Uncertainty is involved with short-term water level observations in boreholes.

The free groundwater surface or groundwater table within unconfined aquifers is generally a subdued reflection of surface topography. Water generally flows downward from upland positions (recharge zones) to low lying areas or surface water bodies (discharge zones). As such, the groundwater level and the amount and level of any perched water on the site may be expected to fluctuate with variations in precipitation, site grading, drainage and adjacent land use. Long-term monitoring utilizing piezometers or observation wells is required to evaluate the potential range of groundwater conditions.



#### 4. LABORATORY TESTING

Our engineering staff reviewed the field boring logs to outline the depth, thickness and extent of the soil strata. The samples taken from the borings were examined in our laboratory and visually classified in general accordance with ASTM D2488, “*Description and Identification of Soils (Visual-Manual Procedure)*.” We established a testing program to evaluate the engineering properties of the recovered samples. A GSI technician performed laboratory testing in general accordance with the following current ASTM test methods:

- Moisture Content (ASTM D2216, “*Laboratory Determination of Water (Moisture) Content of Soil and Rock*”)
- Unit Weight (ASTM D7263, “*Laboratory Determination of Density (Unit Weight) of Soil Specimens*”)
- Atterberg Limits (ASTM D4318, “*Liquid Limit, Plastic Limit, and Plasticity Index of Soils*”)
- Minus No. 200 Sieve Wash (ASTM D1140, “*Amount of Material in Soils Finer Than the No. 200 (75- $\mu$ m) Sieve*”)
- Unconfined Compressive Strength (ASTM D2166, “*Unconfined Compressive Strength of Cohesive Soil*”)

Laboratory test results are presented on the boring logs in Appendix B and tabulated in Appendix C.

Moisture content and unit weight tests were used to evaluate the existing moisture-density condition of the soils. The Atterberg limits and Minus No. 200 sieve tests were used to help classify the soils under the Unified Soils Classification System. The Atterberg limits were also used to evaluate the plasticity characteristics of the soils. Unconfined compression tests were used to define the stress-strain characteristics and related shear strength of the soils.

The following data summarize our laboratory test results. We used these data to develop the allowable bearing values, anticipated settlements, and other geotechnical design criteria for the project.

- Natural Moisture Content..... 10.4 to 25.8%
- Wet Density..... 116.9 to 125.5 lb/ft<sup>3</sup>
- Dry Density..... 100.1 to 102.4 lb/ft<sup>3</sup>
- Unconfined Compressive Strength .....0.78 to 3.31 kips/ft<sup>2</sup>



- Liquid Limit..... 58
- Plastic Limit..... 20
- Plasticity Index ..... 38
- Percent Passing the No. 200 Sieve ..... 89.4%
- Standard Penetration Test (SPT 'N' blows per foot) ..... 7 to 26

Based on the results of this testing program, we reviewed and supplemented the field logs to arrive at the final logs as presented in Appendix B. The final logs represent our interpretation of the field logs and reflect the additional information obtained from the laboratory testing. Stratification boundaries indicated on the boring logs were based on observations made during drilling, an extrapolation of information obtained by evaluating samples from the borings, and comparisons of similar engineering characteristics. Locations of these boundaries are approximate and the transitions between soil types may be gradual rather than clearly defined.



## 5. CONCLUSIONS AND RECOMMENDATIONS

### 5.1 General Geotechnical Considerations

The soils we encountered in the test borings are generally capable of supporting the anticipated loads on shallow foundations. We did not encounter groundwater within the depth of expected excavation.

The near-surface clay soils we encountered at the site are classified as highly plastic and may be susceptible to changes in strength and volume (shrink/swell) with changes in moisture content. These soils are not recommended for direct support of floor slabs unless chemically stabilized as outlined later in this report.

### 5.2 Earthwork

#### 5.2.1 Site Preparation

Adjacent foundations and structures that will remain must be protected (where applicable) while performing excavations and soil improvement programs. Roof drains and stormwater drainage from these structures as well as the surrounding area should be directed away from the proposed construction area.

We recommend existing utilities within the proposed building area be relocated to avoid passing beneath the new structure. Abandoned utility pipes that cannot be removed must be plugged with grout to reduce the potential for future collapse or moisture migration into the subgrade soils. Excavations resulting from utility removal must be replaced with engineered structural fill as outlined in Section 5.2.6.

In preparing the site for construction, surface vegetation and topsoil containing a significant percentage of organic matter should be removed from the areas beneath structures and any other areas that are to be paved, cut or receive fill. The removal depth for this site is expected to be approximately 6 inches. However, the removal depth should be monitored during stripping and adjusted as required. This material should either be removed from the site or stockpiled for later use in landscaping of unpaved or non-structural areas.

After removal of the topsoil, the subgrade should be proof rolled with a loaded tandem axle dump truck or equivalent (loaded water truck, loaded concrete mixer or motor grader with a minimum

weight of 20 tons). A proof-roll is considered acceptable if no ruts greater than one inch deep appear behind the loaded vehicle, and no pumping or weaving is observed as the wheels pass over the area. Any soft or unsuitable areas should be compacted or removed and replaced with stable fill material similar in composition to the surrounding soils. If necessary, clean materials such as crushed concrete or crushed stone may be used to stabilize areas where wet soil or water is present. Geogrid or structural geotextile may be used in conjunction with crushed concrete or stone to provide additional stabilization.

Prior to fill placement, the top 9 inches of the ground surface in fill areas should be scarified, moisture conditioned and recompacted in accordance with Section 5.2.5 to eliminate a plane of weakness along the contact surface.

### **5.2.2 General Structural Fill**

General structural fill should be used for mass site grading, landscaping applications or as utility trench backfill outside of building areas. General structural fill may also be used to within 18 inches of the base of any granular cushion beneath floor slabs. In the former applications, low volume change materials are required immediately below the floor slabs (low volume change material is discussed in the following section).

General structural fill may comprise cohesive or granular material but should be free from organic matter or debris. Granular materials used as general structural fill should be well graded, have a maximum particle size of 1.5 inches, and meet KDOT freeze/thaw durability and sulfate soundness requirements.

If free of organic matter or debris, the on-site soils may be reused as general structural fill within the areas outlined above.

### **5.2.3 Low Volume Change Material (LVC)**

Low volume change (LVC) material as specified for use below floor slabs must consist of material with a liquid limit (LL) less than 40 and a plasticity index (PI) between 10 and 20. LVC material could be a granular material but must have sufficient cohesion to form a compactable, uniform and stable subgrade. This typically translates to a material with greater than 15 percent fines (percent passing the No. 200 sieve). However, silty gravel (such as KDOT AB-3) or limestone screenings are also

acceptable LVC materials. Granular materials with less than 15 percent fines may be used within confined areas such as within foundation stem walls.

The on-site clay soils are not considered LVC material as defined in this section unless chemically stabilized as outlined below.

#### **5.2.4 Chemical Stabilization of Soil**

The highly plastic clay soils we encountered in this exploration are considered moisture sensitive and may lose strength and undergo volume changes with fluctuations in moisture content. The on-site clay soils are not suitable for use as LVC material without chemical stabilization. Chemical stabilization may be achieved by amending the soil with 14 to 16 percent class “C” fly ash, 6 to 8 percent cement kiln dust (CKD), or 3 to 5 percent Portland cement.

We recommend a laboratory standard Proctor Moisture-Density Relationship (ASTM D698, “*Laboratory Compaction Characteristics of Soil Using Standard Effort*”) be performed prior to field mixing using a sample of the soil to be stabilized and the proposed amendment (fly ash, CKD or Portland cement). The sample should be prepared in advance to match the intended field mix proportions, using the same amendment source as will be utilized in the field.

#### **Fly Ash Stabilization**

Prior to the introduction of fly ash, the soil material should be thoroughly pulverized to reduce clods to ½ inch or less. During the pulverization process, we recommend that water be added to reach a moisture content at or above the optimum moisture content as determined by ASTM D698 for the proposed fly ash-soil mixture. The fly ash should remain dry and be protected from external sources of moisture during transportation and storage. Fly ash material that is introduced to moisture prior to incorporation with the soil must be discarded.

The fly ash and soil should be thoroughly mixed within ½ hour after introduction. The moisture content should be field tested immediately following mixing and adjusted as needed to maintain a range between optimum and 4 percent above optimum. The fly ash-soil mixture should not be allowed to air dry. If the moisture content is determined to be in excess of 4 percent of optimum, additional fly ash should be applied to achieve the specified moisture content. Compaction of the fly ash supplemented soil should be completed within 2 hours after incorporation. Additional

compaction after 2 hours may cause degradation of the soil strength. The fly ash-soil mixture should be compacted as noted in Section 5.2.5 (engineered structural fill).

Fly ash mixing should not be performed at ambient air temperatures below 50 degrees Fahrenheit.

### **Cement Kiln Dust**

Cement kiln dust can also be used as a soil stabilization agent and should be incorporated into the soils using the procedures outlined for fly ash stabilization. Cement kiln dust may be used at temperatures below 50 degrees Fahrenheit, provided the soil to be amended is frost-free.

### **Portland Cement**

Type I/II Portland cement can be used as a soil stabilization agent using dry application methods as outlined above, or by injection of a liquefied cementitious mixture into the soil to be treated. Cement treatment and mixing can be performed at temperatures below 50 degrees Fahrenheit, provided the soil to be amended is frost-free.

### **Stabilized Subgrade Maintenance**

Stabilized soil that will be utilized as floor slab subgrade should not be allowed to freeze prior to floor slab placement. If slab placement does not immediately follow soil stabilization, the supplemented soil should be kept moist and trafficking minimized for a curing period of approximately 5 to 7 days following compaction.

If the stabilized subgrade deteriorates prior to paving or slab placement, we recommend any unstable areas be scarified and recompacted. We recommend an additional 4 to 6 percent class "C" fly ash be incorporated in areas that are to be scarified and recompacted. Expansive soils stabilized with cement kiln dust may be reworked without additional amendment. Other soil types may require the incorporation of additional cement kiln dust to restore the desired strength characteristics.

### **5.2.5 Compaction of Engineered Structural Fills**

Unless otherwise noted, fill materials should be placed in loose lifts not to exceed 9 inches and be compacted to a minimum of 95 percent of the maximum dry unit weight obtained from ASTM D698 (Standard Proctor). Moisture content at the time of compaction should be controlled to between optimum and 4 percent above optimum moisture content.

If possible, granular fill materials containing less than 15 percent fines should be compacted to a minimum of 95 percent of the maximum dry unit weight obtained from ASTM D698. Granular fill materials which do not produce a definable moisture-density curve when tested according to ASTM D698 should be compacted to a minimum of 75 percent relative density (ASTM D4253, "*Maximum Index Density and Unit Weight of Soils Using a Vibratory Table*" and ASTM D4254, "*Minimum Index Density and Unit Weight of Soils and Calculation of Relative Density*"). Granular materials should be placed at a moisture content that will achieve the desired densities. Please note that relative density and standard Proctor tests measure different parameters and are not interchangeable.

In general, proper compaction of cohesive soils can be achieved with sheepsfoot or pneumatic-type compactors, while compaction of granular soils can be achieved with smooth-drum or smooth-plate vibratory compactors. Water flooding is not an acceptable compaction method for any soil type.

#### **5.2.6 Utility Trench Backfill**

As a minimum, utility trench backfill material should meet the requirements of general structural fill as defined in Section 5.2.2. Where utility trenches pass beneath structures or flatwork, the upper foot of utility backfill should meet the requirements of LVC material as defined in Section 5.2.3. Backfill soils in utility trenches must be placed in lifts of 6 inches or less in loose thickness and be compacted in accordance with Section 5.2.5.

Controlled low strength material (CLSM) or flowable fill may also be used for utility backfills. We recommend designing flowable fill with a compressive strength between 50 and 300 pounds per square inch (psi). CLSM with a maximum compressive strength less than 300 psi can be readily excavated with a backhoe. The intent for the CLSM is to provide a backfill that can be placed in a single lift, without personnel entering the excavation and without the need for compaction equipment.

Where used beneath flatwork or structures, CLSM should be terminated one foot below the structure, floor slab subgrade elevation. To provide uniform support beneath flatwork and structures, the fill placed over the CLSM should be of similar composition as the surrounding bearing materials and be constructed as moisture-conditioned and compacted engineered structural fill in accordance with Section 5.2.5.

### **5.2.7 Foundation Backfill**

As a minimum, backfill soils for formed foundations should meet the requirements of general structural fill as defined in Section 5.2.2. However, we recommend fill around foundations meet the requirements of LVC material as defined in Section 5.2.3. The use of LVC material to backfill foundations is intended to help reduce desiccation cracking adjacent to the structure, which can provide a pathway for water to infiltrate the foundation subgrade. If other cohesive materials are used to backfill foundations, the risk of differential movements caused by water infiltration into the foundation subgrade may be increased.

We also recommend the upper 18 inches of exterior foundation backfill have sufficient cohesion to direct surface water away from the structure. Granular materials such as sand and gravel are not suitable for use as exterior foundation backfill in the surficial 18 inches.

Backfill soils around formed foundations must be placed in lifts of 6 inches or less in loose thickness and be moisture conditioned and compacted in accordance with Section 5.2.5. Care should be exercised during compaction to avoid applying excessive stress to the foundation surfaces. Where both sides of a foundation wall are backfilled, the fill should be placed simultaneously in uniform lifts on both sides of the wall to reduce unbalanced lateral loads.

### **5.2.8 Correction of Unsuitable Foundation Soils**

If soft, loose, or otherwise unsuitable soils are encountered at the base of any foundations, an over-excavation and replacement/recompaction procedure will be required. The unsuitable soils beneath the foundations should be removed to the required depth, with the excavation extending laterally 9 inches in all directions for each vertical foot of over-excavation. Structural fill for the over-excavated areas should be of similar composition as the surrounding materials or meet the requirements of LVC material as defined in Section 5.2.3. Backfill material should be compacted in accordance with Section 5.2.5. CLSM, as defined in Section 5.2.6 may also be used to backfill over-excavated areas.

### **5.2.9 Excavation Slopes**

Vertical cuts and excavations may stand for short periods of time, but should not be considered stable in any case. All excavations should be sloped back, shored, or shielded for the protection of workers. As a minimum, trenching and excavation activities should conform to federal and local regulations.



The clay soils we encountered in the test borings generally classify as a type “B” soil according to OSHA’s Construction Standards for Excavations. In general, the maximum allowable slope for shallow excavations of less than 20 feet in a type “B” soil is 1.0H:1V, although other provisions and restrictions may apply. If different soil types are encountered, the maximum allowable slope may be different.

The Contractor is responsible for designing any excavation slopes or temporary shoring. The Contractor must also be aware that slope height, slope inclination, and excavation depths (including utility trench excavations) should in no case exceed those specified in federal, state, or local safety regulations, such as OSHA Health and Safety Standards for Excavations, 29 CFR Part 1926, or successor regulations.

Excavations performed near existing structures must not compromise the integrity or support of the existing foundation elements. Shoring, bracing, underpinning or other methods of maintaining foundation integrity may be required.

The information presented in this section is solely for our client’s reference. **GSI assumes no responsibility for site safety or the implementation of proper excavation techniques.**

### **5.3 Foundations**

Based on the subsurface conditions revealed by the boring and testing program, this site appears suitable for use of a shallow foundation system. The selection of an allowable soil bearing pressure for shallow foundation elements must fulfill two requirements. First, the foundation load must be sufficiently less than the ultimate soil bearing capacity to ensure stability. Second, the total and differential settlements must not exceed amounts which will produce adverse behavior of the superstructure.

In order to meet the previous criteria, we have explored both the bearing capacity and the load settlement characteristics of the site soils assuming typical wall loads of 3 kips per lineal foot and typical column loads of 40 kips. The bearing capacity is based on a factor of safety of three against the full dead load plus normal live load. In our analysis, we used a maximum allowable total settlement of 1 inch and a maximum allowable differential settlement of  $\frac{3}{4}$  of an inch within 50 lineal feet. These limits are generally considered acceptable for most structures.



A net allowable soil bearing pressure of 3,000 pounds per square foot (psf) may be used to size continuous strip and spread foundation elements bearing on undisturbed native clay. The allowable bearing pressure is expressed in terms of the net pressure transferred to the soil. The net allowable bearing pressure is defined as the total structural dead load including the weight of the foundation elements, less the weight of the soil excavated for the foundation elements. This value may be increased by one-third for transient loading conditions such as wind or seismic forces.

This site appears to be suitable for the use of trenched “grade beam” type footings. Trenched footings utilize the excavation side walls as a form. Because separate forms do not need to be installed, this type of footing can be constructed more quickly and eliminate the need to backfill the foundation. Stresses applied to the soil by the foundation are also distributed more evenly.

All exterior and any interior foundation elements exposed to freezing conditions should be constructed at least 3.5 feet below the surrounding exterior grade to help reduce the effects of frost and seasonal moisture changes. Interior footings, which will be protected from the effects of frost, may be founded 1.5 feet below finished floor elevation.

We recommend that concrete be placed as soon as practical after footing excavation, with as little disturbance to the bearing soils as possible. Footing excavations should be free of loose soil or debris. Loose or disturbed soil must be removed or compacted prior to foundation construction. Water that collects in the excavations should be promptly removed to prevent softening of the foundation supporting soils prior to concrete placement. In addition, we recommend all excavations be observed by our geotechnical personnel prior to placement of concrete for the possible presence of unsuitable bearing soils. If unsuitable bearing soils are encountered during construction, these areas should be corrected in accordance with Section 5.2.8.

If shallow foundations are designed and constructed in accordance with the recommendations presented, total settlements are not expected to exceed 1 inch with differential settlements less than  $\frac{3}{4}$  of an inch within 50 lineal feet. Total settlement of the addition should be considered differential settlement when designing architectural and structural connections between the addition and the existing structure.



#### 5.4 Floor Slabs

The clay soils we encountered near the surface in our borings are highly plastic and susceptible to changes in strength and volume (shrink/swell) with changes in moisture content. Such changes present a risk of causing slab movement. Most slabs-on-grade will experience some amount of vertical movement, which the Owner must be willing to accept. Recommendations to help reduce the risk of movement of a slab supported on plastic clay soils are presented below.

To provide uniform support for floor slabs and reduce the potential for subgrade volume change, we recommend all floor slabs bear on a minimum of 18 inches of LVC material as defined in Section 5.2.3 (or chemically stabilized on-site soils as outlined in Section 5.2.4). The placement and compaction of the LVC material should conform to the recommendations in Section 5.2.5 of this report. Depending on final grades, some over-excavation of the plastic clay soils may be required to develop the 18-inch layer of LVC material.

By constructing a 18-inch layer of low plasticity, low volume change material immediately beneath the floor slab and closely controlling the moisture and density of the scarified soil and new fill materials, it is our opinion that the potential for detrimental floor slab movement will be reduced to less than  $\frac{3}{4}$  of an inch. However, because of the remaining thickness of the highly plastic soils, the potential for future movement will still exist. A greater thickness of low volume change material beneath the floor slab may further reduce potential slab movement. If slab movements up to  $\frac{3}{4}$  of an inch are not acceptable, please contact GSI for further floor slab recommendations.

We recommend a 2- to 4-inch thick sand cushion be placed beneath the floor slab in addition to the low plasticity, low volume change material. This layer should be free-draining, well-graded and compacted by vibration prior to placing the floor slab. The sand cushion should be moist, but not saturated, at the time of concrete placement.

We also recommend the moisture content of upper 9 inches of the subgrade be checked prior to placement of a sand base, reinforcing steel or concrete floor slab. If the moisture content of the subgrade is below optimum, we recommend the subgrade be scarified, moisture conditioned and recompacted according to Section 5.2.5.



In many construction projects, the moisture content of the floor slab subgrade is tested during grading of the site and then remains exposed until floor slab placement occurs several weeks later. In this situation, even LVC material is subject to some swell movement if not properly moisture conditioned prior to slab placement. Periodic applications of water will help maintain the proper moisture content of subgrade soils. The risk of differential movements can be reduced by creating and properly preparing a LVC zone beneath the slab as well as ensuring proper drainage is maintained around the structure at all times.

We recommend the floor covering manufacturer be consulted regarding the use of a vapor retarder beneath floor slabs. If a vapor retarder is recommended by the floor covering manufacturer, it should conform to the manufacturer's specifications to maintain the product warranty.

### **5.5 Surface Drainage and Landscaping**

The success of the shallow foundation system and slab-on-grade floor system is contingent upon keeping the moisture content of subgrade soils as constant as possible and not allowing surface drainage to have a path to the subsurface soils. Positive surface drainage away from structures must be maintained throughout the design life of the structures. Landscaped areas should be designed and constructed such that irrigation and other surface water will be collected and carried away from foundation elements. Pavements should be sloped or crowned to direct surface water to storm sewer systems or detention/retention ponds.

During construction, temporary grades should be established to prevent runoff from entering excavations or footing trenches. Backfill should be placed as soon as concrete structural strength requirements are met and should be graded to drain away from the building.

The final grade of the foundation backfill and any overlying pavements should have a positive slope away from foundation walls on all sides. We typically recommend a minimum slope of one inch per foot for the first 5 to 10 feet for uncovered surfaces. However, the slope may be decreased if the ground surface adjacent to foundations is covered with concrete slabs or asphalt pavements. For other areas of the site, we recommend a minimum slope of two percent. Pavements and exterior slabs that abut structures should be carefully sealed against moisture intrusion at the joint. All downspouts and faucets should discharge onto splash blocks that extend at least five feet from the

building line or be tied into the storm drain system. Splash blocks should slope away from the foundation walls.

The placement of vegetation and plantings next to the foundation should be minimized. Where landscaping is required, we recommend considering plants and vegetation that require minimal irrigation. Irrigation within ten feet of the foundation should be carefully controlled and minimized.

### **5.6 Construction Considerations**

If construction of the project is to be performed during periods of freezing temperatures, steps should be taken to prevent the soils under floor slabs or footings from freezing. In no case should the fill materials, floor slabs, foundations, or other exterior flat work be placed on frozen or partially frozen materials. Frozen materials should be removed and replaced with a suitable material as described in earlier sections of this report.

Care should be exercised during excavation of new footings to avoid undermining the existing footings. Shoring, bracing, underpinning or other methods of maintaining foundation integrity may be required.

Construction performed during periods of high precipitation may result in saturated unstable soils, and caving or sloughing of excavations. Control of soil moisture will be necessary for successful soil compaction, and to maintain soil bearing capacity.

### **5.7 Construction Observation and Quality Assurance**

We recommend that GSI review those portions of the plans and specifications that pertain to foundations and earthwork to evaluate consistency with our findings and recommendations. GSI will provide up to 2 hours of engineering support services at no charge to review project documents for adherence to our recommendations.

Site grading, including proof-rolling, replacement or recompaction of material, and placement of fill and backfill, should be observed by a quality assurance technician from GSI under the direction of a registered professional engineer. The technician should perform density tests and make any other observations necessary to assure that the requirements of the specifications are being achieved.



It is the opinion of GSI that construction observation by the geotechnical engineer of record or his designated representative is necessary to complete the design process. Field observation services are viewed as essential and a continuation of the design process. Unless these services are provided by GSI, the geotechnical engineer will not be responsible for improper use of our recommendations or failure by others to recognize conditions which may be detrimental to the successful completion of the project.

GSI will be available to make field observations and provide consultation services as may be necessary. A written proposal outlining the cost of construction testing services such as soil, concrete, and steel quality assurance can be provided upon request.



## 6. CLOSING REMARKS AND LIMITATIONS

This report is presented in broad terms to provide an assessment of the subsurface conditions and their potential effect on the adequate design and economical construction of the proposed structure. The analyses, conclusions, and recommendations contained in this report are based on the site conditions existing at the time of the exploration, the project layout described herein, and the assumption that the information obtained from our 4 borings is representative of subsurface conditions throughout the site.

Any changes in the design or location of the proposed structure should be assumed to invalidate the conclusions and recommendations given in this report until we have had the opportunity to review the changes and, if necessary, modify our conclusions and recommendations accordingly. If subsurface conditions different from those encountered in the explorations are observed during construction or appear to be present beneath excavations, GSI should be advised at once so that the conditions can be reviewed and recommendations reconsidered where necessary.

If there is a substantial lapse in time between the submission of this report and the start of construction, or if site conditions or the project layout have significantly changed (due to further development of grading plans, natural causes, or construction operations at or adjacent to the site), we recommend that this report be reviewed to determine the applicability of our previous conclusions and recommendations.

Our geotechnical exploration and subsequent recommendations address only the design and construction considerations contained in this report. We make no warranty for the contents of this report, neither expressed nor implied, except that our professional services were performed in accordance with engineering principles and practices generally accepted at this time and location.

The scope of services for this exploration did not include a wetlands evaluation, an environmental assessment, or an investigation for the presence of hazardous or toxic materials in the soil, surface water, groundwater, or air within or adjacent to this site. If contamination is suspected or is a concern, we recommend the scope of this study be expanded to include an environmental assessment.

This report was prepared by the firm of GSI Engineering, LLC (GSI) under the supervision of a professional engineer registered in the State of Kansas. Report preparation was in accordance with

generally accepted geotechnical engineering practices for the exclusive use of our client for evaluating the design of the project as it relates to the geotechnical aspects discussed herein. Recommendations are based on the applicable standards of the profession at the time of this report within this geographic area. GSI Engineering, LLC will not be responsible for misrepresentation of this report resulting from partial reproduction or paraphrasing of its contents.

We appreciate the opportunity to be of service on this project. Please contact us if we can provide further information regarding the contents of this report or the scope and cost of additional services.

Respectfully submitted,  
GSI Engineering, LLC



Matthew N. Tye, I.E.  
Staff Engineer



Thomas C. Kettler, Jr., P.E.  
Senior Engineer

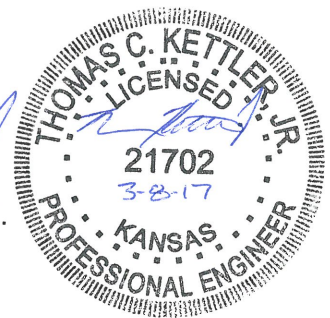

MNT/TCK

*I hereby certify that this engineering document was prepared by me or under my direct personal supervision and that I am a duly licensed Professional Engineer under the laws of the State of Kansas.*

*Sections covered by this seal:*

*Sections 1 through 6 and all pages included as appendices within this bound document.*

G:\JOBS\Wichita\177\1773\1773023\MS Science Wing Addition\Geo-Rpt Science Wing Addition (1773023C).docx

# **APPENDIX A**

---

General Vicinity Map  
Boring Location Plan





FIG. #:	1	PROJ #:	1773023C
DATE:	3/2/17	SCALE:	NTS
DRAWN BY:	MNT	CHECKED BY:	MNT



GSI Engineering, LLC  
 4503 E 47th St S  
 Wichita, KS 67210  
 (316) 554-0725  
 www.gsinetwork.com

ADDENDUM 1  
 12/05/17

**GENERAL VICINITY MAP  
 USD 320 MIDDLE SCHOOL  
 SCIENCE WING ADDITION  
 WAMEGO, KANSAS**



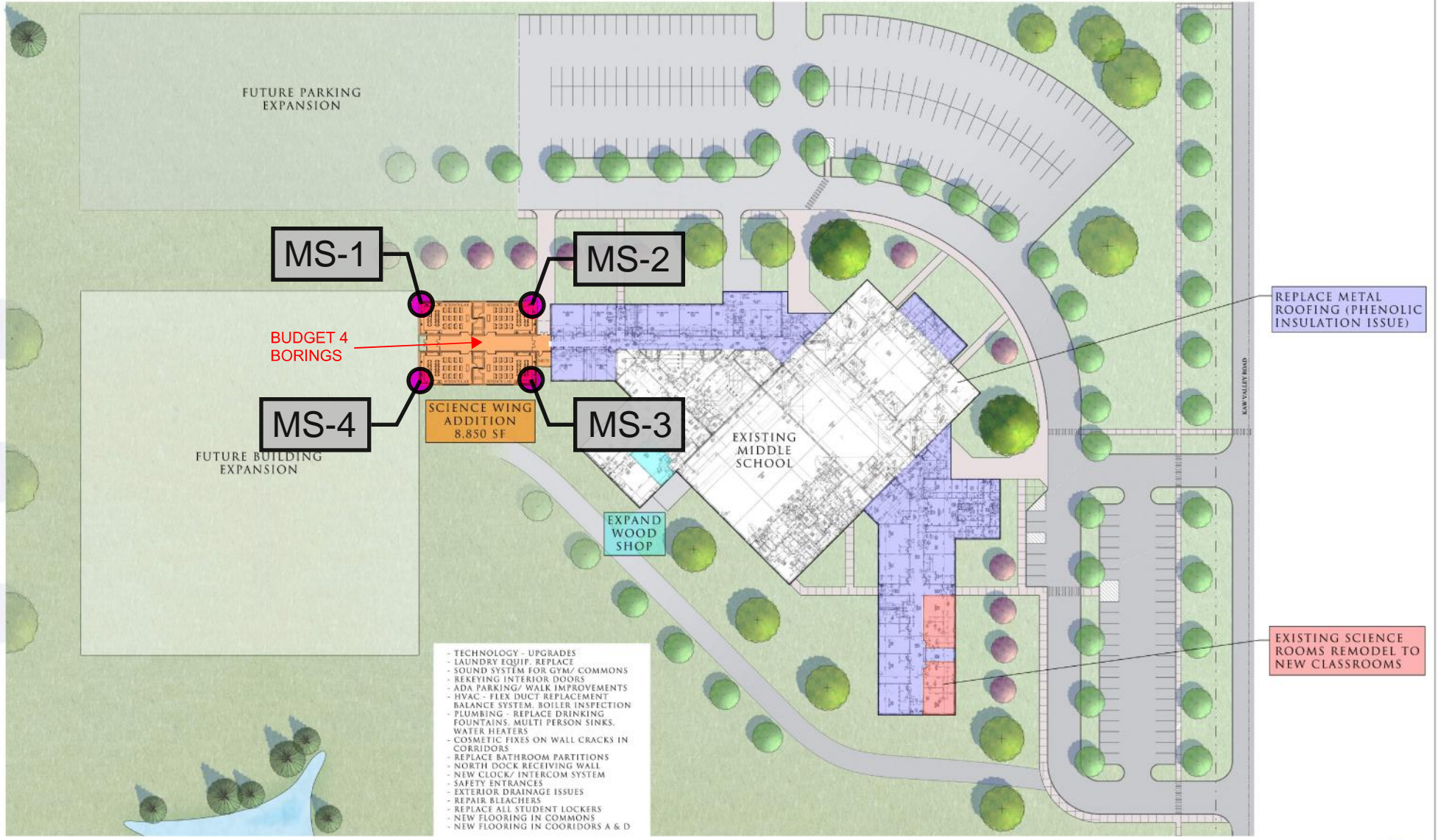

NORTH  
**USD 320 WAMEGO MIDDLE SCHOOL**  
 SITE PLAN  
 0 20 40 60 80 100



## **APPENDIX B**

---

Boring Logs

Key to Symbols

Legend & Nomenclature

Unified Soil Classification System (USCS)

# BORING LOG No. MS-1

BORING NO.	LOCATION OF BORING	ELEVATION	DATUM	DRILLER	LOGGER
MS-1	See Boring Location Plan			J. Tinnell	R. Hopkins
WATER LEVEL OBSERVATIONS			TYPE OF SURFACE		DRILL RIG
WHILE DRILLING	END OF DRILLING	24 HOURS AFTER DRILLING	Grass		Mobile B-61
N.E.	N.E.	Boring Plugged After Drilling	3.25-inch Inside Diameter Hollow Stem Augers		TOTAL DEPTH 10.0 ft.

DEP. FT.	SAMPLE DATA			SOIL DESCRIPTION		LABORATORY DATA			ELEV. FT.
	SAMPLE NO. & TYPE	"N" BLOWS (FT)	% REC.	COLOR, CONSISTENCY, MOISTURE	USCS CLASS.	MC %	Dry Dens. pcf	q <sub>u</sub> ksf	
				GEOLOGIC DESCRIPTION & OTHER REMARKS					
				✓✓✓✓✓	6" TOPSOIL				
	S-1	10		/ / / / /	FAT CLAY- dark gray, moist, stiff LL=58; PL=20; PI=38 % Pass #200: 89.4	CH	23.6		
	S-2	14		/ / / / /	LEAN CLAY- dark yellowish brown, moist, stiff		16.6		
5				/ / / / /	- iron, trace sand, else as above				
	S-3	12		/ / / / /		CL	16.8	100.1	0.78
				/ / / / /	- as above				
10	S-4	12		/ / / / /			13.4		
					Bottom of Boring @ 10'				
15									
20									
25									
30									
35									
40									

# BORING LOG No. MS-2

BORING NO.	LOCATION OF BORING	ELEVATION	DATUM	DRILLER	LOGGER
MS-2	See Boring Location Plan			J. Tinnell	R. Hopkins
WATER LEVEL OBSERVATIONS			TYPE OF SURFACE		DRILL RIG
WHILE DRILLING	END OF DRILLING	24 HOURS AFTER DRILLING	AFTER DRILLING	Grass	Mobile B-61
N.E.	N.E.	Boring Plugged After Drilling		3.25-inch Inside Diameter Hollow Stem Augers	10.0 ft.

DEP. FT.	SAMPLE DATA			SOIL DESCRIPTION		LABORATORY DATA			ELEV. FT.
	SAMPLE NO. & TYPE	"N" BLOWS (FT)	% REC.	COLOR, CONSISTENCY, MOISTURE	USCS CLASS.	MC %	Dry Dens. pcf	q <sub>u</sub> ksf	
				GEOLOGIC DESCRIPTION & OTHER REMARKS					
				✓✓✓✓✓	6" TOPSOIL				
	S-1	9		/ / / / /	FAT CLAY- dark brown, moist, stiff, roots	CH	22.3		
	S-2	14		/ / / / /	LEAN CLAY- dark brown, moist, stiff		22.4		
5				/ / / / /	- as above				
	S-3	16		/ / / / /		CL	18.8		
				/ / / / /					
10	S-4	7		/ / / / /	- dark yellowish brown, medium stiff, trace sand, else as above		17.6		
					Bottom of Boring @ 10'				
15									
20									
25									
30									
35									
40									

# BORING LOG No. MS-3

BORING NO.	LOCATION OF BORING	ELEVATION	DATUM	DRILLER	LOGGER
MS-3	See Boring Location Plan			J. Tinnell	R. Hopkins
WATER LEVEL OBSERVATIONS			TYPE OF SURFACE		DRILL RIG
WHILE DRILLING	END OF DRILLING	24 HOURS AFTER DRILLING	AFTER DRILLING	Grass	Mobile B-61
N.E.	N.E.	Boring Plugged After Drilling		3.25-inch Inside Diameter Hollow Stem Augers	10.0 ft.

DEP. FT.	SAMPLE DATA			SOIL DESCRIPTION		LABORATORY DATA			ELEV. FT.	
	SAMPLE NO. & TYPE	"N" BLOWS (FT)	% REC.	COLOR, CONSISTENCY, MOISTURE		USCS CLASS.	MC %	Dry Dens. pcf		q <sub>u</sub> ksf
				GEOLOGIC DESCRIPTION & OTHER REMARKS						
				✓✓✓✓✓	6" TOPSOIL					
	S-1	12		/ / / / /	LEAN CLAY- dark brown, moist, stiff, root hairs		17.8	102.4	3.31	
	S/U-2	25			- olive brown, very stiff, else as above		22.6			
5	S-3	25			- as above	CL	22.5			
	S-4	7			- dark yellowish brown, medium stiff, trace sand, else as above		18.2			
10					Bottom of Boring @ 10'					
15										
20										
25										
30										
35										
40										

# BORING LOG No. MS-4

BORING NO.	LOCATION OF BORING	ELEVATION	DATUM	DRILLER	LOGGER
MS-4	See Boring Location Plan			J. Tinnell	R. Hopkins
WATER LEVEL OBSERVATIONS			TYPE OF SURFACE		DRILL RIG
WHILE DRILLING	END OF DRILLING	24 HOURS AFTER DRILLING	AFTER DRILLING	Grass	Mobile B-61
N.E.	N.E.	Boring Plugged After Drilling		3.25-inch Inside Diameter Hollow Stem Augers	10.0 ft.

DEP. FT.	SAMPLE DATA			SOIL DESCRIPTION		LABORATORY DATA			ELEV. FT.	
	SAMPLE NO. & TYPE	"N" BLOWS (FT)	% REC.	COLOR, CONSISTENCY, MOISTURE		USCS CLASS.	MC %	Dry Dens. pcf		q <sub>u</sub> ksf
				GEOLOGIC DESCRIPTION & OTHER REMARKS						
				✓✓✓✓✓	6" TOPSOIL					
	S-1	13			FAT CLAY- olive brown, moist, stiff, roots, rust stains	CH	25.8			
	S-2	26			LEAN CLAY- dark yellowish brown, moist, very stiff, trace sand		15.5			
5					- stiff, else as above					
	S-3	14				CL	15.0			
10	S-4	8			- as above		10.4			
					Bottom of Boring @ 10'					
15										
20										
25										
30										
35										
40										

# KEY TO SYMBOLS

Symbol Description

## Strata symbols



Topsoil



High plasticity  
clay



Low plasticity  
clay

## Notes:

1. The exploratory borings were drilled on February 9, 2017 using 3.25-inch inside diameter hollow stem augers.
2. These logs are subject to the limitations, conclusions, and recommendations in this report.
3. Results of tests conducted on samples recovered are reported on the logs.

## Boring Log Legend and Nomenclature

Items shown on boring logs refer to the following:

1. **Depth** - Depth below ground surface or drilling platform
  
2. **Sample** -Types designated by letter:
  - A - Disturbed sample, obtained from auger cuttings or wash water.
  - S - Split barrel sample, obtained by driving a 2-inch split-barrel sampler unless otherwise noted.
  - C - California liner sample, obtained using a thick-walled liner sampler containing 2-inch-diameter liner tubes.
  - U - Undisturbed sample, obtained using a thin-walled tube, 3-inch-diameter, or as noted, and open sampling head.

*Recovery* - Recovery is expressed as a percentage of the length recovered to the total length pushed, driven or cored.

*Resistance* - Resistance is designated as follows:

  - P - Sample pushed in one continuous movement by hydraulic rig action.
  - 12 - The Standard Penetration Resistance is the number of blows for the last 12 inches of penetration of split spoon sampler, driven by a 140-pound hammer falling 30 inches.
  - 50/4" - Number of blows to drive sampler distance shown.
  
3. **Soil Description** - Description of material according to the Unified Soil Classification: word description giving soil constituents, consistency or density, and other appropriate classification characteristics. Geologic name or type of deposit and other pertinent information, where appropriate, is shown under Geologic Description or other Remarks. A solid line indicates the approximate location of stratigraphic change.
  
4. **Lab Data** – Laboratory test data.
  
5. **Legend**

A.D. — After drilling	N.A. — Not Applicable
A.T.D. — At time of drilling	N.D. — Not detectable due to
C.F.A. — Continuous flight auger	drilling method
D.W.L. — Drill water loss	N.E. — None encountered
D.W.R. — Drill water return	N.R. — Not recorded
E.D. — End of drilling	R.Q.D. — Rock quality designation
H.B. — Hole backfilled	R.W.B. — Rotary wash boring
  
6. **Limitations** - The lines between materials shown on the boring logs represent approximate boundaries between material types and the changes may be gradual. Water level readings shown on the logs were made at the time and under the conditions indicated. Fluctuations in the water levels may occur with time. The boring logs in this report are subject to the limitations, explanations and conclusions of this report.



# UNIFIED SOIL CLASSIFICATION SYSTEM

GROUP NAME	GROUP SYMBOL	SOIL DESCRIPTION	COMMENTS
Peat	Pt	Highly Organic Soils	50% or More Is Smaller than No. 200 Sieve
Fat Clay	CH	Clay - Liquid Limit $\Rightarrow$ 50*	
Elastic Silt	MH	Silt - Liquid Limit $\Rightarrow$ 50*	
Lean Clay	CL	Clay - Liquid Limit $<$ 50*	
Silt	ML	Silt - Liquid Limit $<$ 50*	
Silty Clay	CL-ML	Silty Clay*	
Clayey Sand	SC	Sands with 12 to 50% Smaller than No. 200 Sieve	More than 50% Is Larger than No. 200 Sieve and % Sand $>$ % Gravel
Silty Sand	SM	Sands with 5 to 12% Smaller than No. 200 Sieve	
Poorly-Graded Sand with Clay	SP-SC	Sands with Less than 5% Smaller than No. 200 Sieve	
Poorly-Graded Sand with Silt	SP-SM		
Well-Graded Sand with Clay**	SW-SC		
Well-Graded Sand with Silt**	SW-SM		
Poorly-Graded Sand	SP	Gravels with 12 to 50% Smaller than No. 200 Sieve	
Well-Graded Sand**	SW		
Clayey Gravel	GC	Gravels with 5 to 12% Smaller than No. 200 Sieve	More than 50% Is Larger than No. 200 Sieve and % Gravel $>$ % Sand
Silty Gravel	GM		
Poorly-Graded Gravel with Clay	GP-GC		
Poorly-Graded Gravel with Silt	GP-GM		
Well-Graded Gravel with Clay**	GW-GC		
Well-Graded Gravel with Silt**	GW-GP		
Poorly-Graded Gravel	GP	Gravels with Less than 5% Smaller than No. 200 Sieve	
Well-Graded Gravel**	GW		

\*See Plasticity Chart for definition of silts and clays. If organic, use OL or OH.  
 \*\*See definition of well-graded

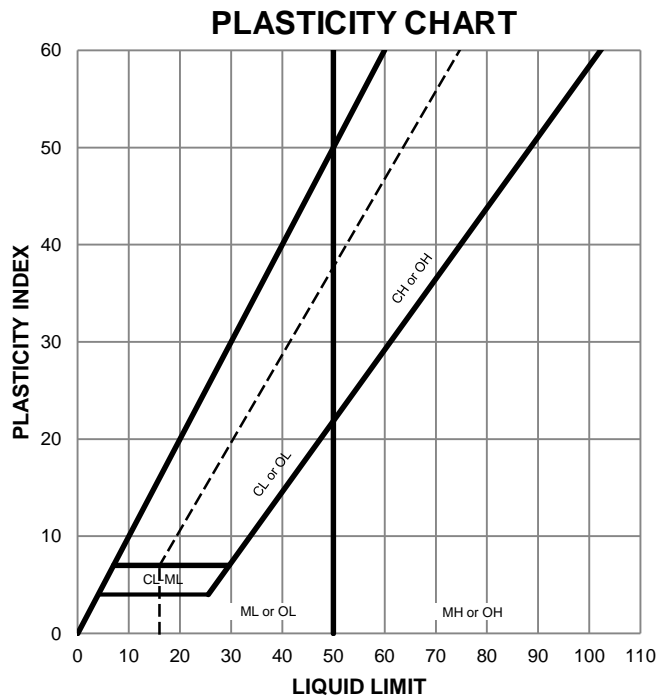

### LEGEND OF TERMS

MOISTURE CONDITIONS
Dry, Slightly Moist, Moist, Very Moist, Wet (Saturated)

#### SOIL CONSISTENCY

##### *Fine-Grained Soils*

Description	SPT (N)	UCS ( $q_u$ , tsf)
Very Soft	0-2	0-0.25
Soft	2-4	0.25-0.50
Medium Stiff	4-8	0.50-1.0
Stiff	8-16	1.0-2.0
Very Stiff	16-32	2.0-4.0
Hard	$>$ 32	$>$ 4.0

##### *Coarse-Grained Soils*

Description	SPT (N)
Very Loose	0-4
Loose	4-10
Medium Dense	10-30
Dense	30-50
Very Dense	$>$ 50

### CLASSIFICATION OF SANDS & GRAVELS

Boulders	Cobbles	Coarse Gravel	Fine Gravel	Coarse Sand	Medium Sand	Fine Sand	Fines (Silt or Clay)
10"	3"	3/4"	#4	#10	#40	#200	

Well-Graded Sands (SW):  $C_u \geq 6$  and  $1 \leq C_c \leq 3$

Well-Graded Gravels (GW):  $C_u \geq 4$  and  $1 \leq C_c \leq 3$



# **APPENDIX C**

---

## Field & Laboratory Test Results

Boring No.	Sample No.	Sample Depth (ft)	Sample Type	Sample Diameter (in)	Sample Length (in)	Moisture Content (%)	Wet Unit Weight (lb/ft <sup>3</sup> )	Dry Unit Weight (lb/ft <sup>3</sup> )	Unconfined Compressive Strength (kips/ft <sup>2</sup> )	Atterberg Limits			Percent Passing No. 200 Sieve	Blow Counts SPT 'N' (blows/ft)	USCS Soil Classification
										Liquid Limit	Plastic Limit	Plasticity Index			
MS-1	S-1	0.5-2.0	Split Spoon			23.6				58	20	38	89.4	10	CH
	S-2	2.5-4.0	Split Spoon			16.6								14	CL
	S/U-3	5.0-6.5	Split Spoon	2.85	5.58	16.8	116.9	100.1	0.78					12	CL
	S-4	8.5-10.0	Split Spoon			13.4								12	CL
MS-2	S-1	0.5-2.0	Split Spoon			22.3								9	CH
	S-2	2.5-4.0	Split Spoon			22.4								14	CL
	S-3	5.0-6.5	Split Spoon			18.8								16	CL
	S-4	8.5-10.0	Split Spoon			17.6								7	CL
MS-3	S-1	0.5-2.0	Split Spoon			17.8								12	CL
	S/U-2	2.5-4.0	Split Spoon	2.85	5.58	22.6	125.5	102.4	3.31					25	CL
	S-3	5.0-6.5	Split Spoon			22.5								25	CL
	S-4	8.5-10.0	Split Spoon			18.2								7	CL
MS-4	S-1	0.5-2.0	Split Spoon			25.8								13	CH
	S-2	2.5-4.0	Split Spoon			15.5								26	CL
	S-3	5.0-6.5	Split Spoon			15.0								14	CL
	S-4	8.5-10.0	Split Spoon			10.4								8	CL



GSI Engineering, LLC  
4503 E. 47th Street South  
Wichita, KS 67210  
(316) 554-0725  
www.gsinetwork.com

**SUMMARY OF FIELD AND LABORATORY TEST RESULTS**

Project: **USD 320 Middle School Science Wing Addition**

Location: **Wamego, Kansas**

Job Number: **1773023C** Date: **3/2/2017**